

## ▶ Cap and Chain for Receptacle

### DMS25043- □ □ DK-F

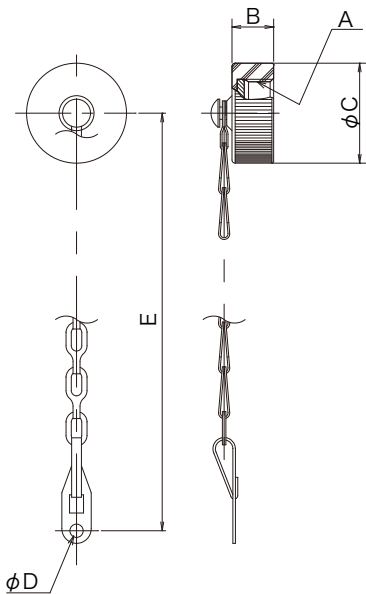

《Fastenning the cap and chain》

Fasten the chain hole "D" to the mounting screw of receptacle.

Part Number	Applicable Shell Size	A	B max.	φ C max.	φ D <sup>+0.25</sup>	E <sup>±13.3</sup>
DMS25043-12DK-F	12S	3/4-20UNEF	11.91	25.40	3.6	170.8
DMS25043-14DK-F	14S	7/8-20UNEF	11.91	28.58	3.6	170.8
DMS25043-16DK-F	16S, 16	1-20UNEF	11.91	30.18	3.6	170.8
DMS25043-18DK-F	18	1 1/8-18UNEF	11.91	34.13	3.6	170.8
DMS25043-20DK-F	20	1 1/4-18UNEF	11.91	37.31	3.6	170.8
DMS25043-22DK-F	22	1 3/8-18UNEF	11.91	40.49	3.6	170.8
DMS25043-24DK-F	24	1 1/2-18UNEF	11.91	43.66	4.4	170.8
DMS25043-28DK-F	28	1 3/4-18UNS	13.49	50.01	4.4	170.8
DMS25043-32DK-F	32	2-18UNS	13.49	56.36	4.8	170.8
DMS25043-36DK-F	36	2 1/4-16UN	13.49	62.71	4.8	170.8

A cap and chain is designed to cover the mating face from dust to avoid electrical trouble.

The moistureproof gasket is attached to the cap and chain (DMS25043- □ □ DK-F) .

(Note) When using the smaller shell size less than 22 of cable receptacle(DMS3101A-F),  
the chain can not be fasten to the cable clamp.

© Specifications and/or dimensions in this catalog are subject to change without notice.  
Your checking the latest specifications with our drawings would be highly appreciated.